

# MIPRO<sup>®</sup>

## User Guide

### ACT-30HC / ACT-32HC

### Rechargeable Handheld Transmitter



**MIPRO<sup>®</sup>**  
MICROPHONE PROFESSIONALS

**MIPRO Electronics Co., Ltd**

Headquarters : 814 Pei-Kang Road, Chiayi, 60096, Taiwan  
Tel : +886.5.238.0809 Fax : +886.5.238.0803  
www.mipro.com.tw mipro@mipro.com.tw

All rights reserved. MN 014/06

Do not copy or forward without prior approvals MIPRO.

Specifications and design subject to change without notice.



2CE495A

## Contents

- 1 Handheld Controls and Indicators
- 3 Operating instructions for insertion & removing battery
- 5 MP-80 Battery Charger (Optional)
- 6 Rear cap has an On/Off switch protection
- 7 General tips for improving system performance

## Handheld Controls and Indicators

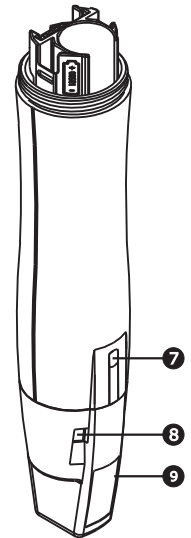
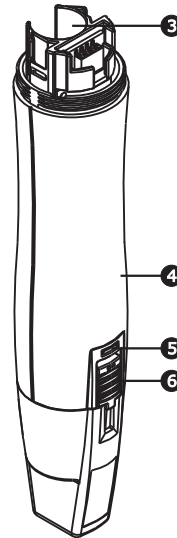
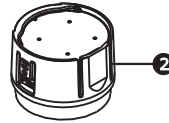
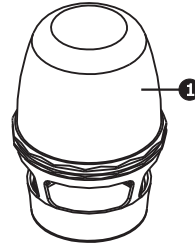

- ❶ **Capsule Module:** Protects detachable microphone capsule module and internal foam prevents breathing, wind and POP noises.
- ❷ **Fixed Ring**
- ❸ **Battery Compartment:** Accommodates one 18500 rechargeable battery.
- ❹ **Housing:** Protects transmitter PCB, battery compartment and battery.
- ❺ Ascertain the power is turn "ON" to see battery status.
  - **Normal Battery:** Red indicator is on for a second and goes off after power on.
  - **Weak Battery:** Red indicator stays on continuously after power on. Recharge or insert a new recharged battery.
  - **No red indicator light:** battery is completely drained or polarity inserted incorrectly.
- ❻ **Power On/Off Switch:** Always power off the transmitter to conserve battery life when not in use.
- ❼ **ACT Infrared (IR) Sync Port:** Receives signals from receiver to synchronize frequencies automatically.
- ❽ **Battery Charging Contact:** Align contacts during charging.
- ❾ **Color Coded Protection Cap:** Protects against accidental power on/off. Available in different colors for channel differentiation.

### Operating instructions for insertion & removing battery

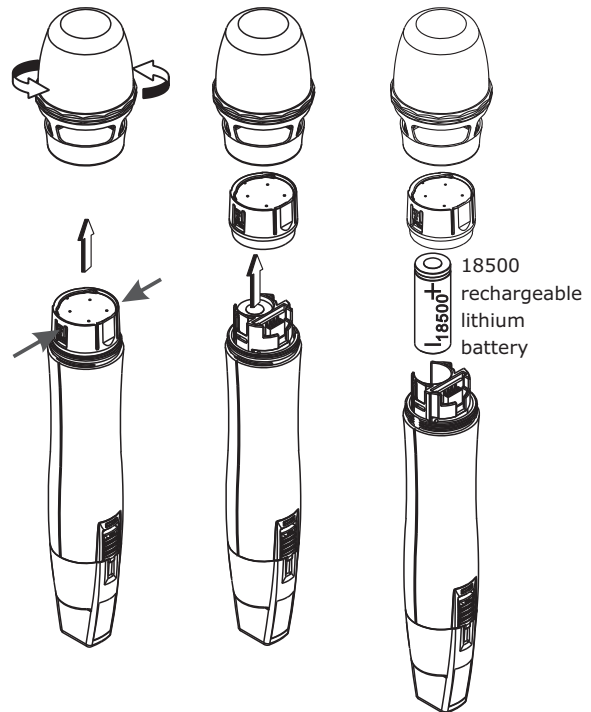

- Remove grill in counter clock direction.
- Press and hold both sides of microphone capsule module and remove gently.
- Ascertain the battery is inserted according to its correct polarity. A click is heard once correctly inserted and grill can be closed properly. No click is heard and grill cannot be closed properly if battery is inserted with the wrong polarity.

NOTE: Transmitter cannot be powered on with a charged battery.

- Check for correct polarity insertion (+ facing up).
- If inserted with correct polarity and still cannot be powered on it could be due to battery protection mechanism is in effect. Insert the whole transmitter back to the battery charger for 10 seconds to "wake-up" and power on again.
- If battery charger is not used, reverse battery polarity for 10 seconds then re-inserted with correct polarity to wake up the battery. Power on again.

### MP-80 Battery Charger (Optional)

MP-80 Charger charges both transmitters and 18500 rechargeable batteries.

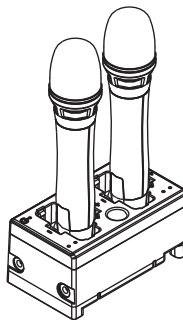

Transmitters Charging

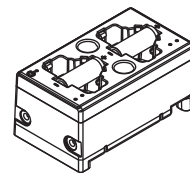

18500 Charging

## Rear cap has an On/Off switch protection

The patented color rear cap serves two purposes; it provides easy channel identification and protects the on/off switch. It is designed to allow the on/off switch to either be exposed or concealed as desired. You can avoid unintended switching off of the microphone by rotating the color rear cap 180 degrees to cover the on/off switch completely. The cap can be removed by gripping it firmly and pulling; be sure to push it firmly into place when replacing it on the microphone.

NOTE: During microphone usage, the color rear cap must be installed.

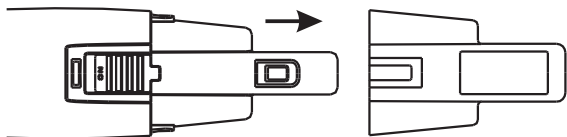

Press both sides and pull out to remove rear cap

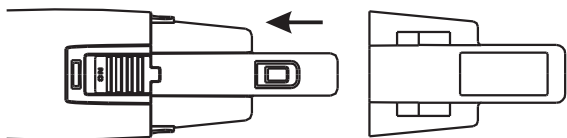

Turn rear cap 180 degree and insert back  
ON/OFF is covered

## General Tips for Improving System Performance

1. Performer should avoid holding the microphone over or near the antenna section as this will deteriorate transmission efficiency. Severe deterioration if performer directly covers up the antenna section with both hands.
2. Many performers tend to hold the microphone by the top grille. Unfortunately, this position seriously degrades both the sound quality and directionality of a microphone. Even the most expensive microphones will have its original sound quality compromised by this method. Grabbing a microphone by the grille will isolate the capsule's acoustic resonance circuit and or change the capsule resonator's frequency. This results in an inferior performance in both frequency response and the separation of directionality. In addition, a palm's sound-focusing effect will tend to strengthen resonances in certain frequencies and can cause unwanted echo.
3. A proper technique is required for using directional microphones because the distance between the microphone and your mouth has a significant impact on sensitivity and performance. There is an inverse relationship between microphone sensitivity and the distance from the mouth to the microphone. Consequently, performers with a "weaker" sound level cannot expect to hold the microphone too far away from their mouth and compensate by turning up the amplifier volume to increase the sound level as this can easily cause echo or feedback. In contrast, performers with a "louder" sound level should not hold the microphone too close as this can easily result in distortion by causing the amplifier system to be overloaded.

4. Furthermore, a large-diaphragm directional microphone has a very distinct proximity effect. When the microphone is close to the mouth, the bass response is strengthened as the distance gets closer. Therefore, if a performer's sound is insufficient in bass, they can hold the microphone closer and use the proximity effect to help compensate for the lower bass level. Conversely, if a performer's voice is too heavy in the bass register, increasing the distance between the microphone and their mouth will decrease the proximity effect and reduce the bass response, thus making their voice become clearer and brighter.
5. It is recommended to keep the grille and sponge windscreen clean to avoid any substance blocking the proximity effect of the microphone.

### Notes

1. Refer to actual product in the event of product description discrepancy.
2. Frequency range and maximum deviation comply with the regulations of different countries.

### **WARNING**

1. **FOR OUTDOOR USE:**  
To reduce the risk of fire or electric shock, do not expose this apparatus to rain or moisture.
2. **UNDER WET LOCATION:**  
Apparatus should not be exposed to dripping or splashing and no objects filled with liquids, such as vases should be placed on the apparatus.
3. **SERVICE INSTRUCTIONS:**  
CAUTION - These servicing instructions are for use by qualified service personnel only. To reduce the risk of electric shock, do not perform any servicing other than that contained in the operating instructions unless you are qualified to do so.

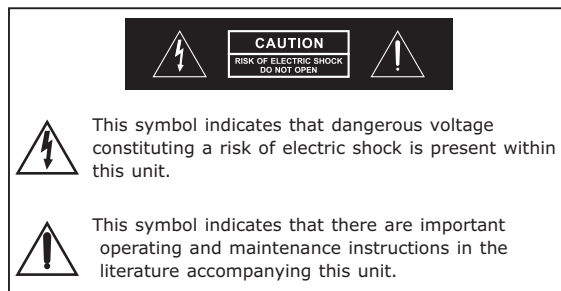

**Disposal** Dispose of any unusable devices or batteries responsibly and in accordance with any applicable regulations.



2006-08-19

Disposing of used batteries with domestic waste is to be avoided!

Batteries / NiCad cells often contain heavy metals such as cadmium(Cd), mercury(Hg) and lead(Pb) that makes them unsuitable for disposal with domestic waste. You may return spent batteries/accumulators free of charge to recycling centres or anywhere else batteries/accumulators are sold.

By doing so, you contribute to the conservation of our environment!

**FCC**

THIS DEVICE COMPLIES WITH PART 74 OF THE FCC RULES.

OPERATION IS SUBJECT TO THE FOLLOWING TWO CONDITIONS:

- (1) This device may not cause interference.
- (2) This device must accept any interference, including interference that may cause undesired operation of the device.

This equipment complies with FCC RF radiation exposure limits set forth for an uncontrolled environment.

**IC**

This device complies with Industry Canada RSS-123 ISSUE 2 standards. Operation is subject to the following two conditions:

- (1) this device may not cause interference, and
- (2) this device must accept any interference, including interference that may cause undesired operation of the device.

Le présent appareil est conforme aux CNR d'Industrie Canada applicables aux appareils radio exempts de licence.

L'exploitation est autorisée aux deux conditions suivantes:

- (1) l'appareil ne doit pas produire de brouillage, et
- (2) l'utilisateur de l'appareil doit accepter tout brouillage radioélectrique subi, même si le brouillage est susceptible d'en compromettre le fonctionnement.