

K SERIES DATA SHEETS

MODEL:

K6010 1

K6012 2

K6015 3



MODEL : **K6010**

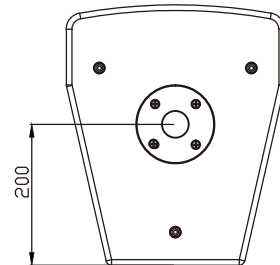
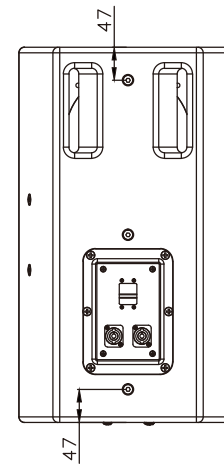
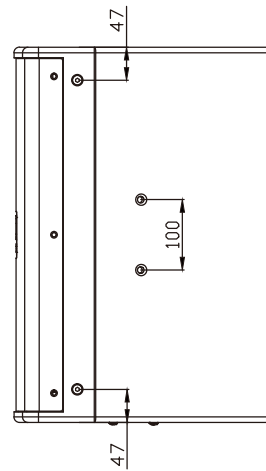
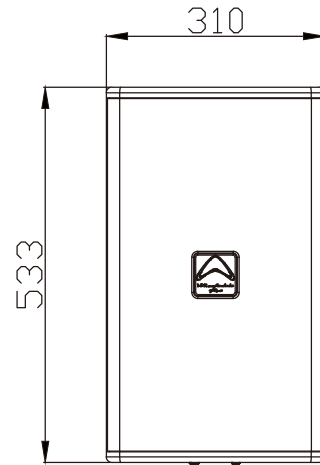
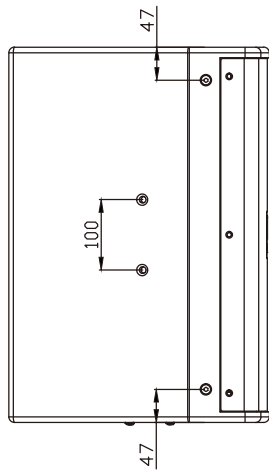
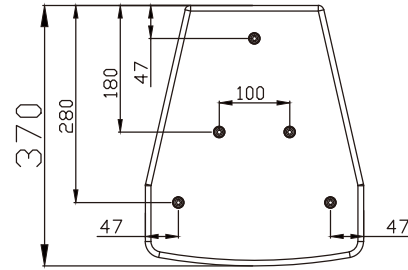

Model Name	K6010
System Type	Passive
Configuration	two-way
Frequency Response (+/-3dB)	65Hz-20kHz
Sensitivity 2.83V/1M	96dB
Calculated Maximum SPL @1M	127dB
System Rated Impedance	8Ω
Low Frequency Transducer	
Size (mm / inches)	288mm / 10"
Voice Coil Size (mm / inches)	63.5mm / 2.5"
LF Magnet Material	Ferrite
LF Frame Material	Aluminium
Rated Impedance	8Ω
High Frequency Transducer	
HF Driver Type	Compression Driver
Voice Coil Size (mm / inches)	44mm / 1.75"
Diaphragm Material	Polyethylene
Nominal Coverage (H x V)	70° x 70°
Power	
System Continuous Power	300w
System Programme Power	600w
System Peak Power	1200w
Crossover Frequency	2.9kHz
Input Connector	2 x Neutrik NL4MP
Rigging	M8 x19
Pole Mount	35mm pole socket
Handles	No
Cabinet Type	Trapezoid
Enclosure Material and finish	15mm plywood
Colour Options	Black paint
Grille Material & Finish	Steel
Dimensions - Unpacked	
Height	533mm
Width Front	310mm
Width Rear	210mm
Depth	335mm
Net Weight	18.9kg



MODEL : **K6012**

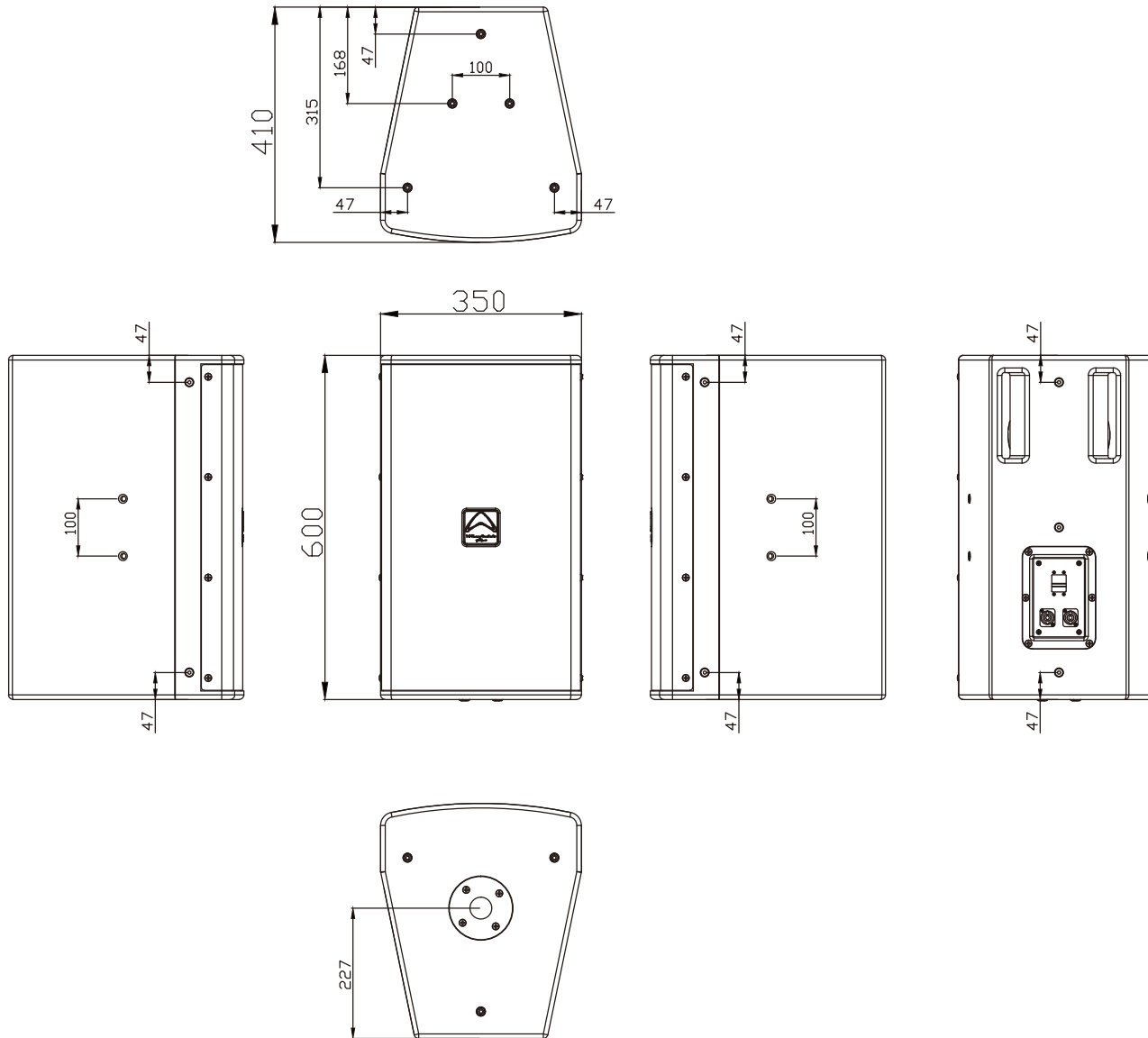

Model Name	K6012
System Type	Passive
Configuration	two-way
Frequency Response (+/-3dB)	60Hz-20kHz
Sensitivity 2.83V/1M	97dB
Calculated Maximum SPL @1M	129dB
System Rated Impedance	8Ω
Low Frequency Transducer	
Size (mm / inches)	305mm / 12"
Voice Coil Size (mm / inches)	75mm / 3.0"
LF Magnet Material	Ferrite
LF Frame Material	Aluminium
Rated Impedance	8Ω
High Frequency Transducer	
HF Driver Type	Compression Driver
Voice Coil Size (mm / inches)	44mm / 1.75"
Diaphragm Material	Polyethylene
Nominal Coverage (H x V)	70° x 70°
Power	
System Continuous Power	400w
System Programme Power	800w
System Peak Power	1600w
Crossover Frequency	3.75kHz
Input Connector	2 x Neutrik NL4MP
Rigging	M8 x19
Pole Mount	35mm pole socket
Handles	No
Cabinet Type	Trapezoid
Enclosure Material and finish	15mm plywood
Colour Options	Black paint
Grille Material & Finish	Steel
Dimensions - Unpacked	
Height	600mm
Width Front	350mm
Width Rear	242mm
Depth	382mm
Net Weight	24.3kg

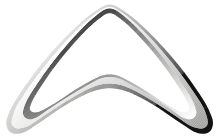

Wharfedale
Pro

MODEL : **K6015**

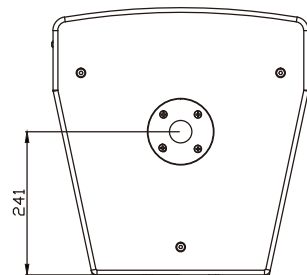
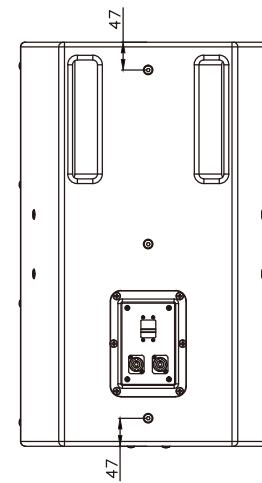
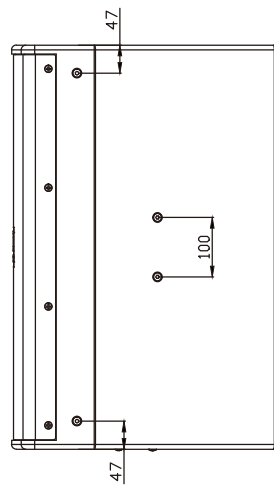
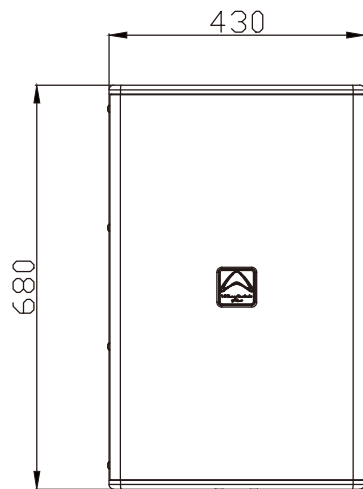
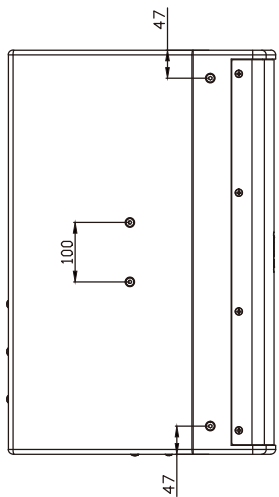
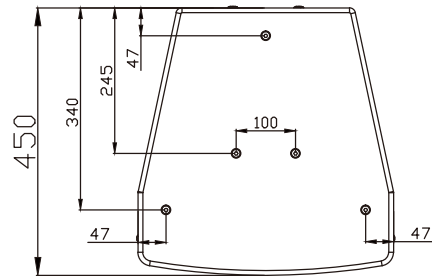

Model Name	K6015
System Type	Passive
Configuration	two-way
Frequency Response (+/-3dB)	45Hz-20kHz
Sensitivity 2.83V/1M	98dB
Calculated Maximum SPL @1M	131dB
System Rated Impedance	8Ω
Low Frequency Transducer	
Size (mm / inches)	381mm / 15"
Voice Coil Size (mm / inches)	75mm / 3.0"
LF Magnet Material	Ferrite
LF Frame Material	Aluminium
Rated Impedance	8Ω
High Frequency Transducer	
HF Driver Type	Compression Driver
Voice Coil Size (mm / inches)	44mm / 1.75"
Diaphragm Material	Polyethylene
Nominal Coverage (H x V)	70° x 70°
Power	
System Continuous Power	500w
System Programme Power	1000w
System Peak Power	2000w
Crossover Frequency	3.2kHz
Input Connector	2 x Neutrik NL4MP
Rigging	M8 x19
Pole Mount	35mm pole socket
Handles	No
Cabinet Type	Trapezoid
Enclosure Material and finish	15mm plywood
Colour Options	Black paint
Grille Material & Finish	Steel
Dimensions - Unpacked	
Height	680mm
Width Front	430mm
Width Rear	298mm
Depth	450mm
Net Weight	29.3kg

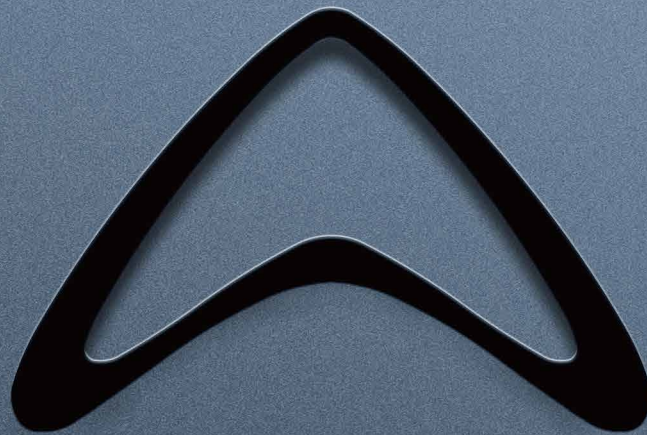

WWW.WHARFEDALEPRO.COM

IAG HOUSE, 13/14 GLEBE ROAD, HUNTINGDON, CAMBRIDGESHIRE,
PE29 7DL, UK
TEL: +44(0) 1480 452 561