

PS-510M Dual Input Power Supply With Personal Mix

Thank you for choosing JTS PS-510M Dual Of Supply With Personal Mix.
In order to obtain the best efficiency, you are recommended to read this manual before using.

Feature

- PS-510M the Dual input power supply provides 9V(by using a 9V battery) / 12~48 V(by using power from the mixer) phantom power to condenser microphones.
- Two mini XLR (M) inputs.
- Separate volume controls can be set independently, which make PS-510M work as a personal mixer.
- Reliable plastic belt clip makes it easy to attach PS-510M to a belt.
- Earphone output for musician to monitor a preferred mix.
- Ideal for CX-500Du Violin microphone and CX-516 accordion microphone.

Parts Identification

- 1 Case
- 2 Audio Input Socket (4P Mini XLR, Male)
- 3 Audio Output Socket (3P XLR, Male)
- 4 Volume Control
- 5 Power On / OFF / Low Batt. Indicator
- 6 Phantom / Batt. Switch
- 7 On / Mute Switch
- 8 Belt Clip
- 9 Battery Compartment
- 10 Output MIC. / Line Level Switch
- 11 Earphone Jack (3.5mm dummy stereo)
- 12 Earphone Volume Control

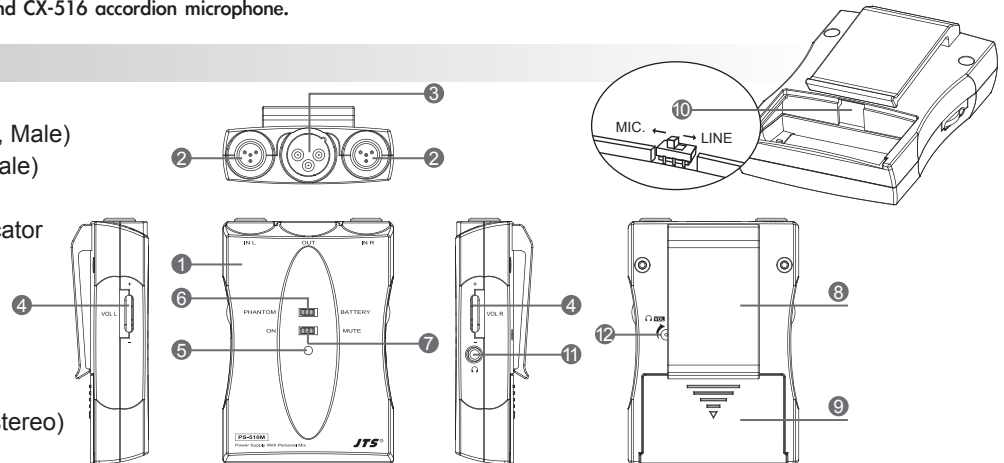

Use Instruction

Installation (Figure 1)

1. Connect one or two microphones to the XLR inputs. (IN L / IN R)
2. Connect the XLR output to a mixer by using an audio cable.
3. Switch MIC. / LINE switch to match the output level to the input of the connected mixer.

Operation

1. Insert one piece of 9V battery to the battery compartment.
2. Switch phantom / Batt. to power the PS-510M. (Figure 2)
3. Switch On / Mute: On: Audio output enabled, earphone output disabled, audio output disabled.
Mute: earphone output enabled.
4. Adjust the volumes of the right and left inputs to have a preferred mix. (Figure 3)

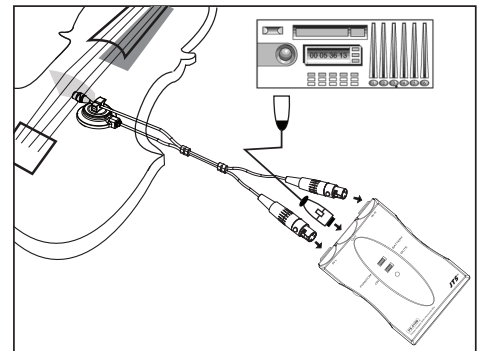

Figure 1

LED Indicator

LED indicator shows the On / OFF / Low Batt. status. (Figure 2)
When the LED lights up GREEN, the PS-510M is ON and the power supply is normal.
Low Batt. : LED RED

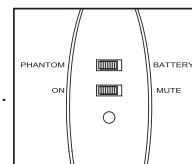

Figure 2

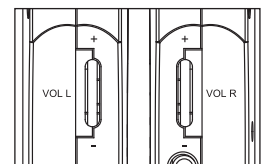
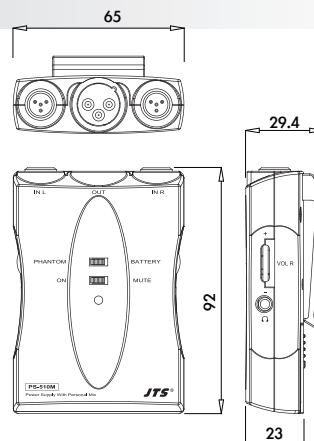

Figure 3

Specification

Frequency Response: 20 to 20 KHz
Power Supply: Battery Power 9V / Phantom Power 12~48V
Current Consumption: max. 85mA with earphone
Input Impedance: 5k Ω
Output Impedance: 470 Ω balanced
Input Connector: 4P Mini XLR (M) (2 channels)
Output Connector: 3P XLR (M)
Earphone output: 3.5mm dummy stereo
Dimension(m/m) : 92mm(W) * 23mm(H) * 65mm(D)



Note:

The earphone output will work only under battery power.

JTS[®] PROFESSIONAL CO., LTD.
No. 148, 9th Industry Road, Ta-Li Industrial Park,
Taichung City, Taiwan, R.O.C.
Tel: 886-4-24938803 Fax: 886-4-24914890
E-mail: jts@jts.com.tw
www.jts.com.tw



59010-510-03

